

# GDT Product Specification

## LG3R8\*\*\*L DIP Gas Discharge Tube (Φ8×10mm)



### 1、FEATURES

- 3-Electrode DIP Design UL Certificated E232249
- High Current Handling Capability 5,000A @ 8/20μs
- Low Capacitance and Insertion Loss
- Fast Response and Long Service Life
- Reliable to Protect Electrostatic Surge
- Moisture sensitivity level: Level 1



### 2、AVAILABLE PART NUMBER AND ELECTRICAL PARAMETER @ T=25°C RH = 45%-75%

Part Number	DC Breakdown Voltage①	Tolerance of Vs	Impulse Spark-over Voltage 1kV/μs⑤	Impulse Discharge Current②④ 8/20μs	Insulation Resistance		C③ (1MHz) 0.3V <sub>DC</sub>
	100V/s⑤				GΩ	DC	
LG3R8-070L	70V	±25%	≤650V	5,000A	≥1	25V	≤1.5pF
LG3R8-090L	90V	±25%	≤650V	5,000A	≥1	50V	≤1.5pF
LG3R8-150L	150V	±25%	≤600V	5,000A	≥1	50V	≤1.5pF
LG3R8-230L	230V	±20%	≤550V	5,000A	≥1	100V	≤1.5pF
LG3R8-350L	350V	±20%	≤750V	5,000A	≥1	100V	≤1.5pF
LG3R8-420L	420V	±20%	≤800V	5,000A	≥1	100V	≤1.5pF
LG3R8-470L	470V	±20%	≤850V	5,000A	≥1	250V	≤1.5pF
LG3R8-600L	600V	±20%	≤950V	5,000A	≥1	250V	≤1.5pF

- ①、The parameters of all are tested by ITU-T K12
- ②、Total Impulse Discharge Current 5,000A @ 8/20μs by IEC 61000-4-5, 10 shots
- ③、The capacitance are tested by 1MHz @ DC= 0.3V
- ④、Currents through center electrode, half value through each line electrode
- ⑤、The V-T waveform of DCBV and IPBV must lie between the shades.

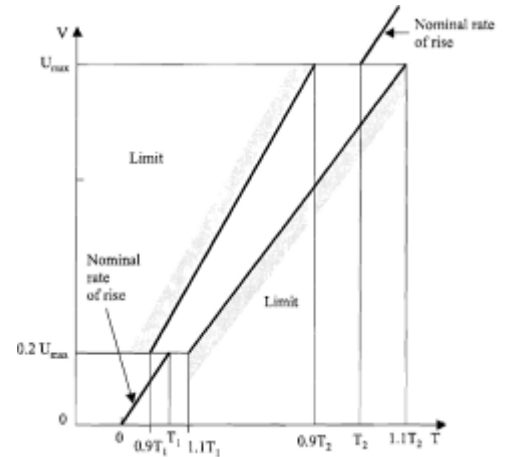

### 3、PART NUMBERING SYSTEM

**LG3R8**      **XXX**      **L**  
(1)            (2)            (3)

- (1) LAN 3-Electrod DIP Gas Discharge Tube :
- ①、3R-Φ8×10 (mm)
  - (2) DC Breakdown Voltage, e.g., 090=90V
  - (3) Surge Rating @8/20μs, L=5KA, M=20KA, H=20KA

### 4、MARKING DIMENSIONS AND RECOMMENDED FLOW

Surface Mark

LG3R8-090L-Part Number

# GDT Product Specification

## LG3R8\*\*\*L DIP Gas Discharge Tube (Φ8×10mm)



Dimensions (unit :mm)

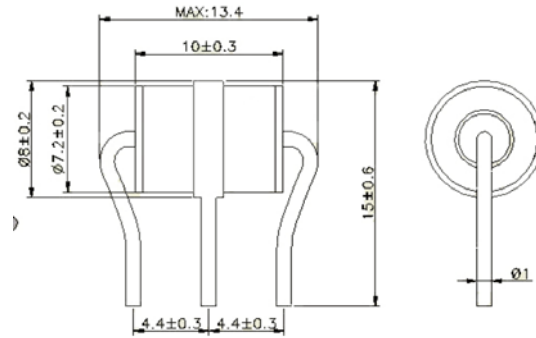

Recommended Flow

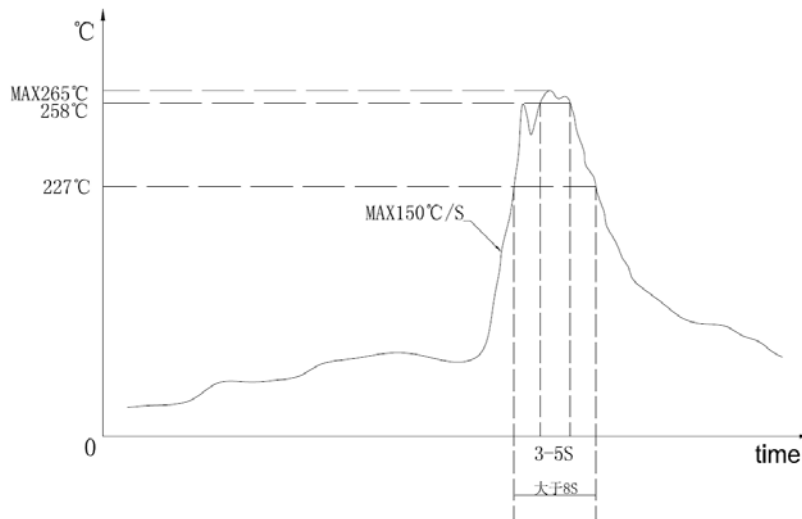

5、 OPERATION AND STORAGE TEMPERATURE: -40°C ~ +85°C

6、 PACKAGE BOX INFORMATION

OUTLINE	UNIT WEIGHT (g)	BOX (PCS)	INSIDE CARTON (PCS)	PER CARTON (PCS)	CARTON SIZE(mm)		
					L	W	H
BOX	~1.9	100	1,000	6,000	395	370	225

Remark:

Date Issued:2010/08